

HONDALINE®

INSTRUCTION MANUAL
FAIRING KIT FOR CB900F

MANUEL D'INSTRUCTION
KIT DE CARENAGE POUR LA CB900F

'81
'82

CB900F FAIRING KIT

NOTE: This fairing is designed for use only on the CB900F motorcycle.

The following steps are necessary to install this kit on your motorcycle: 1) Re-routing of the headlight circuits and 2) Adjustment and inspection of the installation.

Improper installation or adjustment of any of the above may create an unsafe vehicle. In order to prevent improper installation, we strongly urge you to have the kit installed by your Honda Dealer.

PARTS LIST

Index No.	Part Name	Q'ty	Index No.	Part Name	Q'ty
(1)	Fairing Assy	1	(28)	Screw, pan, 6 x 17 mm (black)	4
(2)	Leg shield, Right	1	(31)	Plug, handle lever bracket	2
(3)	Leg shield, Left	1	(32)	Nut, flange, 4 mm	2
(4)	Pillar, Right	1	(33)	Plate, windshield screen	2
(5)	Pillar, Left	1	(34)	Screw B, windshield screen	4
(6)	Rubber screen base	1		4 x 8 mm	
(7)	Windshield screen	1	(35)	Fairing bracket, RR	1
(8)	Headlight mounting Assy	1	(36)	Retainer, R	1
(9)	Turn signal mounting rubber, RR	2	(37)	Retainer, L	1
(10)	Knee pad bracket, Right	1	(38)	Holder, coupler	1
(11)	Knee pad bracket, Left	1	(39)	Cover, holder	1
(12)	Knee pad, Right	1	(40)	Bracket, R, leg shield	1
(13)	Knee pad, Left	1	(41)	Bracket, L, leg shield	1
(14)	Sub wire harness B	1	(42)	Mounting rubber, leg shield	2
(15)	Collar C (white) 6 mm, $\ell = 9$ mm	4	(43)	Collar, front fender 6 mm,	4
(16)	Screw, pan head,	4		$\ell = 12$ mm	
	6 x 17 mm(white)		(44)	Collar, front fender 6 mm,	2
(17)	Grommet, pad setting	4		$\ell = 4$	
(18)	Nut, flange, 6 mm	4	(45)	Bolt, flange, 8 x 22 mm	6
(19)	Screw, tapping, 4 x 12 mm	4	(46)	Nut, 6 mm	4
(20)	Retainer, wire harness	1	(47)	Bolt, flange, 6 x 20 mm	2
(21)	Washer, plain, 6 mm	1	(48)	Bolt, special, 6 x 22 mm	4
(22)	Collar, windshield screen 6mm,	4	(49)	Bolt, flange, 6 x 12 mm	2
	$\ell = 9$ mm		(50)	Bolt, flange, 8 x 30 mm	2
(23)	Cap, windshield screw	8	(51)	Stopper, right turn signal	1
(24)	Screw, windshield screen	4	(52)	Stopper, left turn signal	1
	4 x 13 mm		(53)	Plug, chain case	4
(25)	Washer, plain, 4 mm	4	(54)	Rear view mirror, R	1
(26)	Nut, 6 mm	1	(55)	Rear view mirror, L	1
(27)	Collar, C1(black) 6mm, $\ell = 9$ mm	4	(56)	Screw, pan head, 6 x 28 mm	4

Index No.	Part Name	Q'ty	Index No.	Part Name	Q'ty
(1A)	Headlight shield	1	(8A)	Bracket, meter	1
(2A)	Caution label, tire	1	(9A)	Holder, left shield bracket	2
(3A)	Caution label, tire	1	(10A)	Reflex reflector, front	2
			(11A)	Bracket, R, horn	1
(6A)	Retainer, R, fairing main bracket	1	(12A)	Bracket, L, horn	1
(7A)	Retainer, L, fairing main bracket	1	(13A)	Bolt, flange, 6 x 25 mm	2

Fig. 1-A

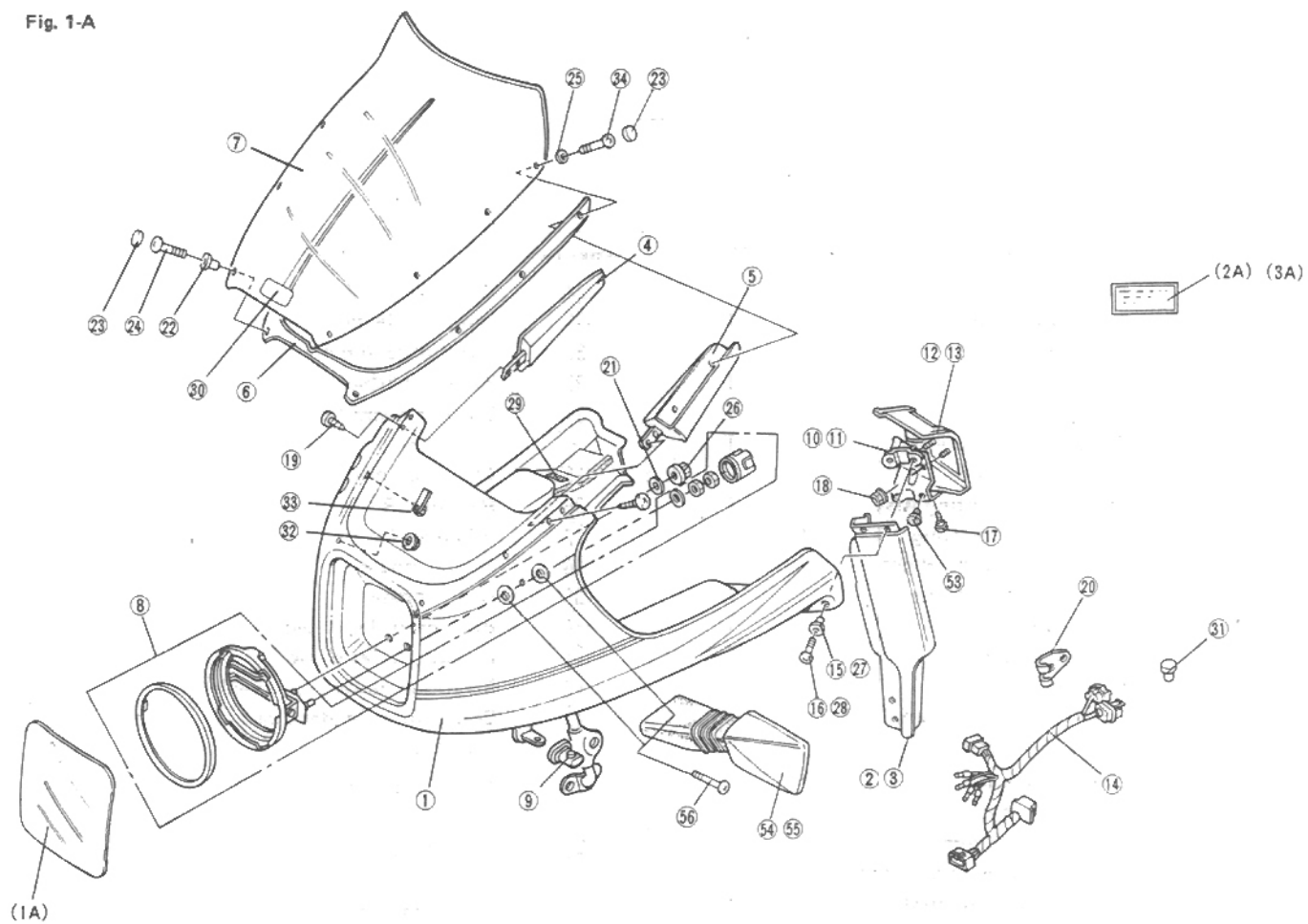
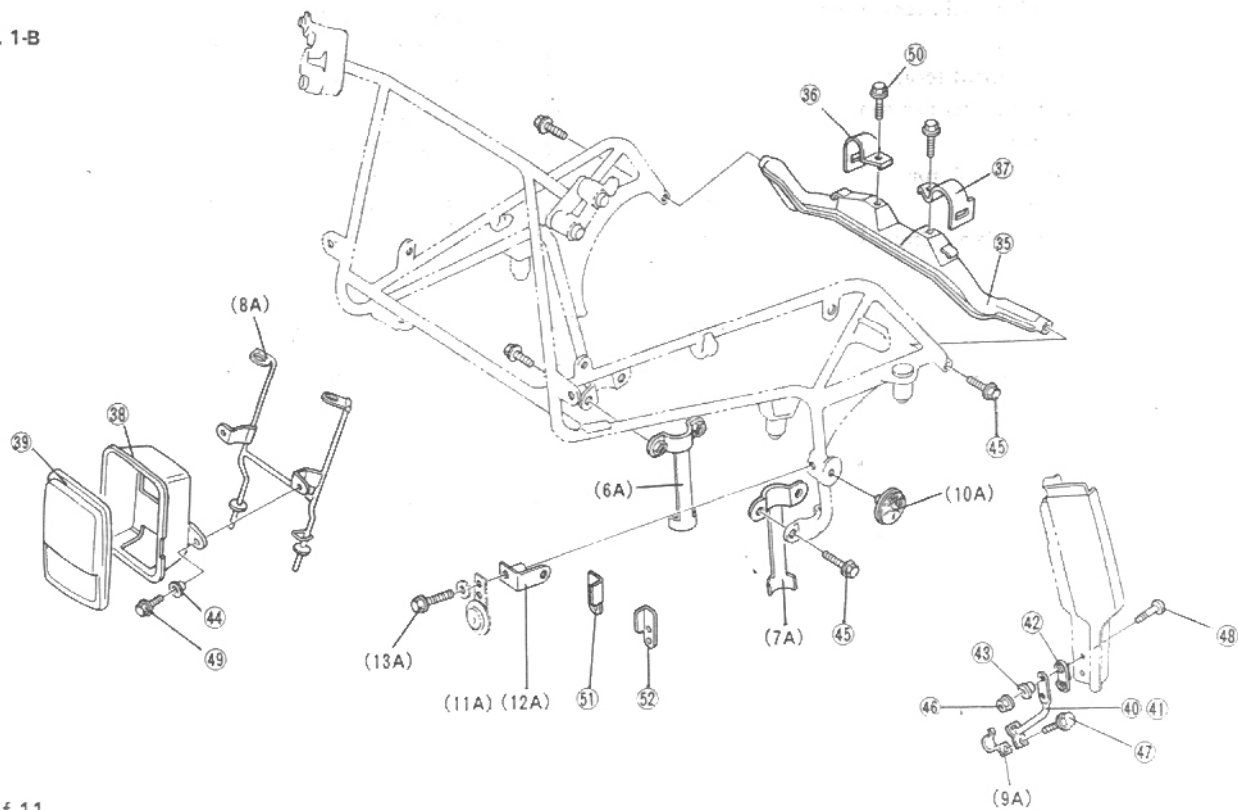

Fig. 1-B



TOOLS REQUIRED

- 8, 10, 12 and 14 mm combination wrenches
- Screwdriver (+)
- 6 mm socket
- Torque wrench

PRECAUTIONS

- Proper torque of the attaching hardware is essential.
Be sure to tighten all bolts, nuts and other fasteners to their specified torques.
- Standard torque values:

Item	Torque Value N·m (kg·m) (ft·lb)
6 mm bolt and nut	8-12 (0.8-1.2) (6-9)
8 mm bolt and nut	18-25 (1.8-2.5) (13-18)
10 mm bolt and nut	30-40 (3.0-4.0) (22-29)
6 mm screw	7-11 (0.7-1.1) (5-8)
8 mm flange bolt and nut	10-14 (1.0-1.4) (7-10)
10 mm flange bolt and nut	30-40 (3.0-4.0) (22-29)

- Refer to the Shop Manual for detailed procedures.

INSTALLATION

(Removal of Parts)

- 1) Remove the seat.
- 2) Remove the battery ground cable from the negative battery terminal.
- 3) Remove the fuel tank.
NOTE: Turn the fuel valve OFF and disconnect the fuel line first, then remove the fuel tank.
- 4) Remove the headlight and retain only the headlight unit and bulb.
- 5) Disconnect the wire harness connectors inside the headlight case.
- 6) Remove and discard the headlight case.
- 7) Remove the horns and discard only the horn emblem, brackets, sub wire harness and flange bolts.
NOTE: After removing the horn bracket, be sure to retighten the 2-way joint 6 mm nuts.

- 8) Remove the right and left front turn signals. Discard the mounting rubbers.
- 9) Remove the headlight case bracket as follows:

Fig. 2

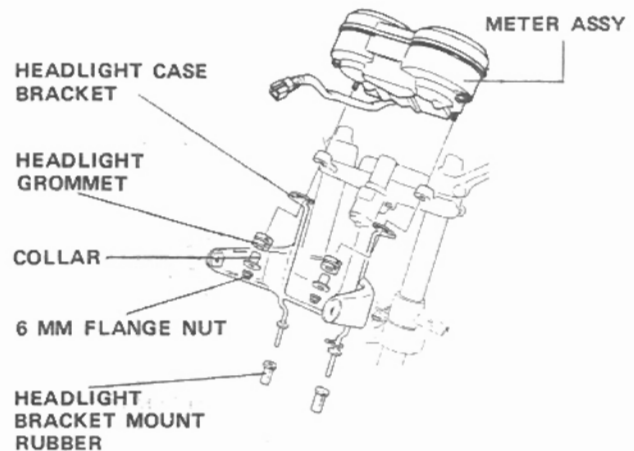

- a. Disconnect the tachometer cable from the tachometer.
- b. Disconnect the speedometer cable from the speedometer.
- c. Remove the meter mounting bolts (one on each side of the meter assembly). Remove the two flange bolts while lifting the meters up.
- d. Disconnect the ignition switch wire coupler.
- e. Remove the headlight case bracket by lifting it upward as shown in Fig. 2 and discard only the headlight case bracket.

NOTE: Do not force the wires and cables when removing the headlight case bracket.

(Fairing mount installation)

- 1) Install the meter bracket (8A) and meter assembly as follows;

Fig. 3

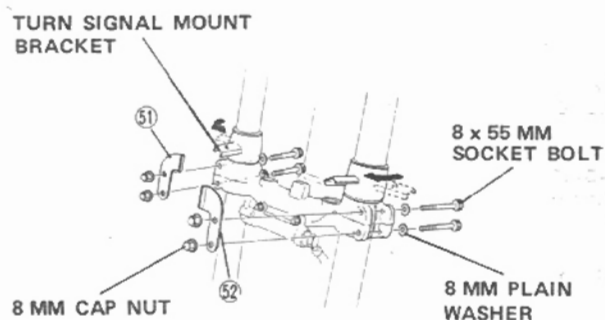
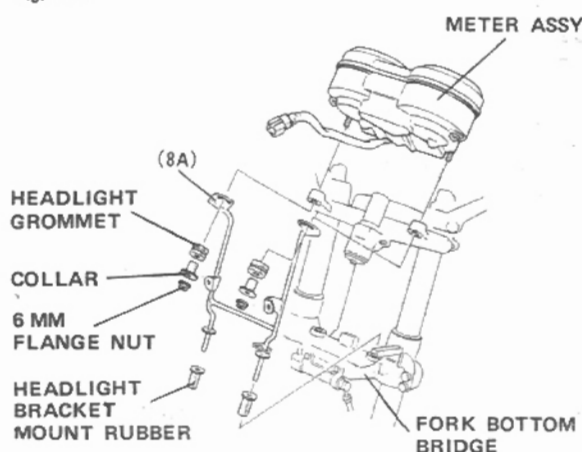

Fig. 4-A



- a. Rotate the right and left turn signal brackets in the arrow directions as shown in Fig. 3. Position the right and left turn signal stoppers 51 and 52 on the fork bottom bridge and install using the 8 x 55 mm socket bolts and 8 mm cap nuts.

NOTE: Tighten the 8 mm bolts and cap nuts to the specified torques.

- b. Install the headlight bracket mount rubbers and headlight grommets on the meter mount bracket (8A) and insert the grommets into holes of the fork bottom bridge. Reinstall the meter assembly on the meter bracket (8A).

NOTE: Tighten the bolts and nuts to the specified torques.

- c. After securing the right and left turn signal mount brackets with the stoppers 51 and 52, bend the brackets in the arrow direction as shown.

Fig. 4-B

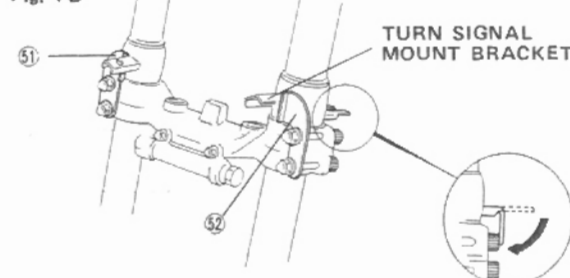

- 2) Re-route the ignition switch wires as follows:

- a. Disconnect the ignition switch connector.
- b. Connect the sub wire harness 14 connector to the ignition switch connector.

Fig. 5-A

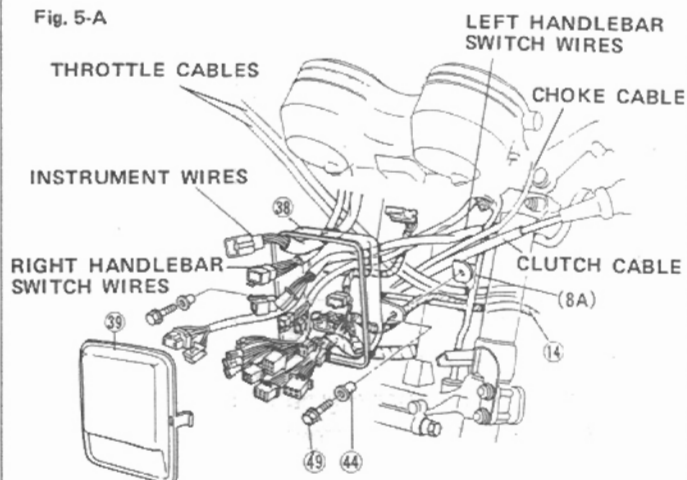

- 3) Route the wire harness and sub wire harness forward through the coupler holder 38. Position the coupler holder 38 on the meter bracket (8A) and install using the two collars 44 and 6 x 12 mm flange bolts 49.

Fig. 5-B

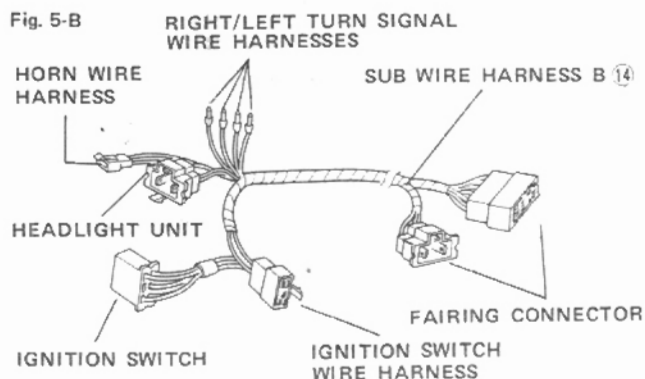

- 4) Connect the main and sub wire harness couplers and connectors color-to-color inside the coupler holder 38.

Fig. 5-C

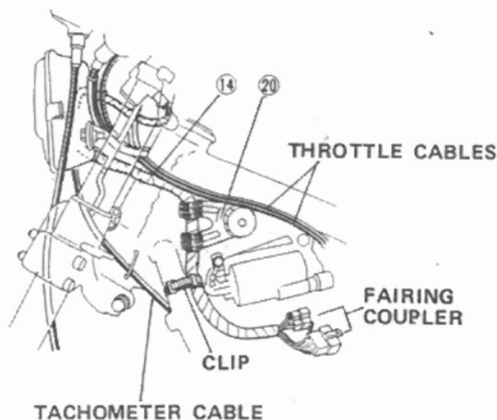

- 5) Secure the sub wire harness 14 with the wire harness holder 20 and clip.

NOTE:

- Check that the locking tab of each coupler is applied securely.
- Check that all wires are connected properly before proceeding to the next step.

- 6) Position the cover 39 on the coupler holder and install using the attaching hardware. Tighten securely.

Fig. 5-D

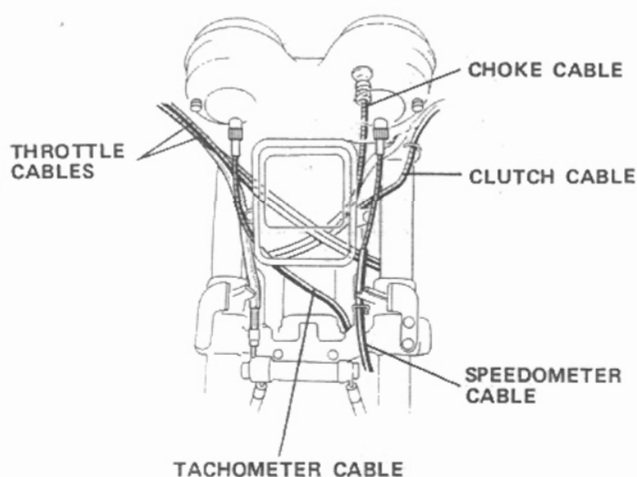

- 7) Route the tachometer, speedometer and choke cables as shown in Fig. 5-D.

- 8) Install the windshield screen 7 on the fairing assembly 1 as follows:

NOTE: Place the fairing assembly on a work bench covered with clean cloth.

Fig. 6

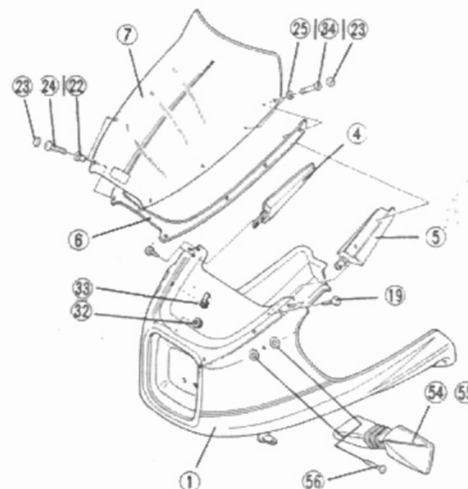

- a. Position the right and left rear view mirrors 54 and 55 on the fairing 1 and install using the two 6 x 28 mm pan head screws 56 for each.

NOTE: Make sure that the mirrors are positioned properly before tightening the screws.

- b. Position the right and left side pillars 4 and 5 on the fairing 1 and install using the two 4 x 12 mm tapping screws 19 for each.

- c. Position the screen rubber base 6 and screen 7 on the fairing and loosely install the front of the screen using the two screws 24, collars 22 and plates 33. Insert the two screws 24 through the second holes and install the collars 22 and 4 mm nuts 32 on the ends of the screws. Loosely install the screen 7 using the four screws 34 and 4 mm washers 25 at the third and fourth holes.

- d. Tighten all screws and nuts and place a cap (23) on top of each screw.

NOTE: Be careful to avoid distorting the upper projection when installing the windshield screen.

- 9) Install the headlight mount (8) and headlight unit as follows:

Fig. 7

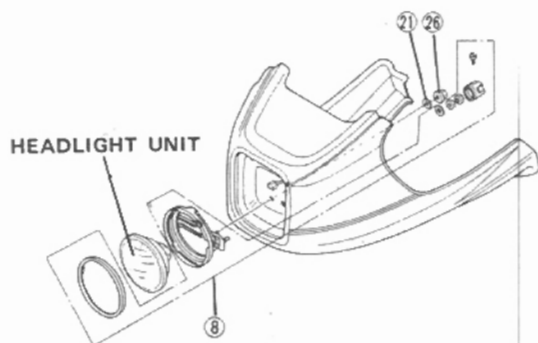

- a. Insert the headlight unit in the headlight mount (8), then install the headlight mount on the fairing using the 6 mm flange nuts (26) and 6 mm plain washers (21). Connect the headlight receptacle to the wire harness.
- NOTE: Tighten the 6 mm flange nuts to the specified torque.

- 10) Install the rear fairing bracket (35) on the frame as follows:

Fig. 8-A

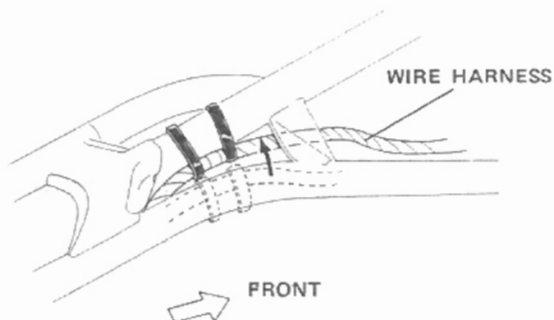

Fig. 8-B

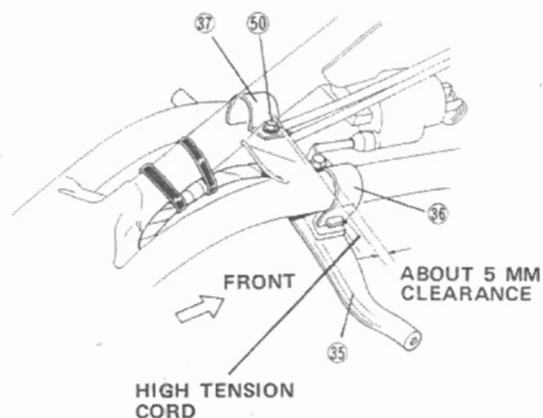
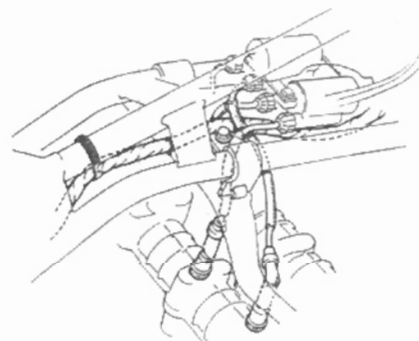

Fig. 8-C



- a. Move the wire harness sidewise as shown in Fig. 8-A.
- b. Position the rear fairing bracket (35) on the frame as shown in Fig. 8-B and loosely install using the two fairing retainers (36 and 37) and 8 x 30 mm flange bolts (50). Note the location of the wire harness and high tension cords.

- 11) Install the fairing assembly on the motorcycle as follows:

Fig. 9-A

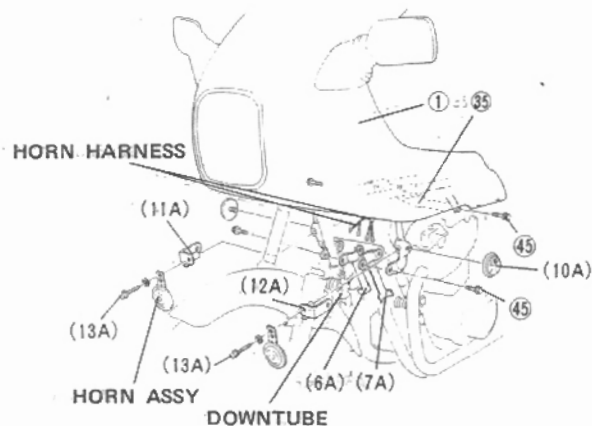

- a. Position the fairing assembly ① over the motorcycle and loosely install the front of the fairing assembly ① using a retainer (6A)/(7A) and two 8 x 22 mm flange bolts ④⑤ for each fairing main bracket. Make sure that the end of each retainer is contacting the forward engine hanger plate.
- b. Loosely attach the rear of the fairing using an 8 x 22 mm flange bolt on each side.

NOTE:

- Check that the fairing assembly is centered on the motorcycle properly.
 - Tighten six 8 x 22 mm flange bolts ④⑤ and two 8 x 25 mm flange bolts ⑤⑥ to the specified torque.
- c. Connect the sub wire harness ⑭ to the coupler inside the fairing. Secure the sub wire harness ⑭ with the two clamps as shown in Fig. 9-B.

Fig. 9-B

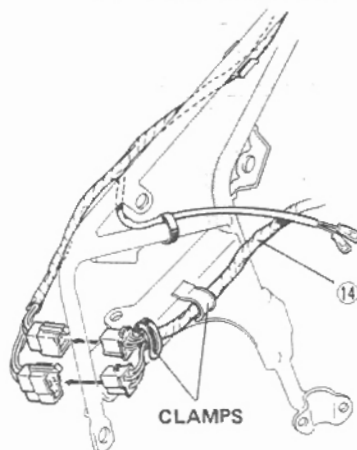

- d. Install the horns using a 6 mm plain washer, horn bracket (11A)/(12A) and 6 x 25mm flange bolt (13A) for each. Connect the horn wires to the wire terminals on the horns.
- e. Check the headlight for horizontal aim by turning the headlight switch ON.
- f. Install the reflex reflectors (10A) as shown.

- 12) Install the right and left leg shields ② and ③ as follows:

Fig. 10-A

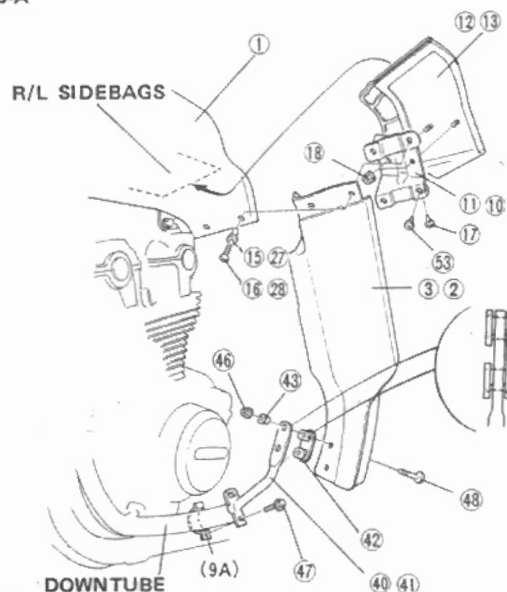

- a. Assemble the knee pads ⑫ and ⑬ with the knee pad brackets ⑩ and ⑪ with the two 6 mm flange nuts ⑱ for each combination. Install the two plugs ⑤③ and grommet ⑱ for each.
 - b. Position the above assemblies on the leg shields ② and ③ and loosely install using the two collars ⑮ and ⑲ and 6 x 17 pan head screws ⑮ and ⑲ for each.
- NOTE:**

- The collars ⑮ and ⑲ and pan head screws ⑮ and ⑲ are available in two colors, black and white. Discard the ones which do not match the color of the fairing.
- Make sure that the upper grooves of the knee pads ⑫ and ⑬ are seated over the ends of the side bags inside the fairing.

- c. Install the cushion rubbers (42) on the leg shield brackets (40) and (41). Position the leg shield brackets (40) and (41) on the downtubes and install using a retainer (9A) and 6 x 20 mm flange bolt (47) for each. Do not tighten at this time.

Care should be taken when installing the leg shields (2) and (3) so that the clearance between the ends of the 6 x 22 mm special bolts (48) and right/left covers is over 5 mm. Also make sure that the right and left leg shield brackets (40) (41) are not interfering with the covers.

Fig. 10-B

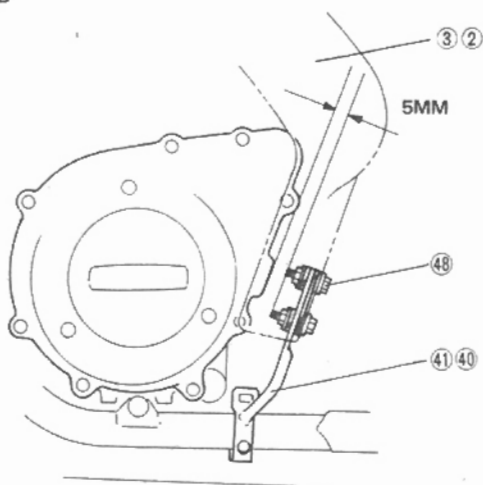

- d. Attach the top of the leg shield brackets to the shields using the two 6 x 22 mm special bolt (48), collars (43) and 6 mm nuts (46) for each. Tighten securely.
- e. After making sure that the leg shields are positioned properly, tighten the pan head screws (16) and (28) and flange bolts (47).
NOTE: Tighten the bolts to the specified torque.

13) Install the headlight shield (1A).

Fig. 11

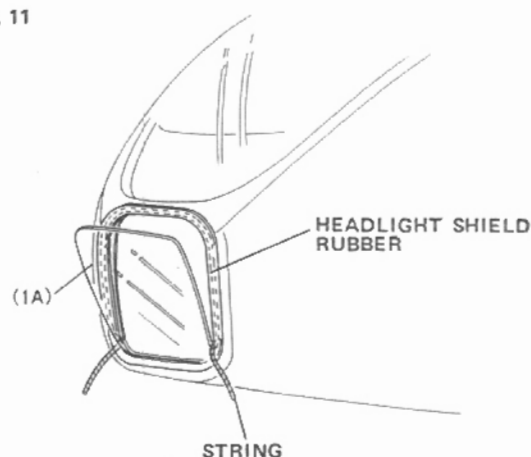

- a. Run a string through the groove of the headlight shield rubber and install the headlight shield (1A) while pulling the string out as shown.
NOTE: Apply soap water to the edge of the shield to facilitate installation.

14) Install the right and left front turn signals as follows:

Fig. 12-A

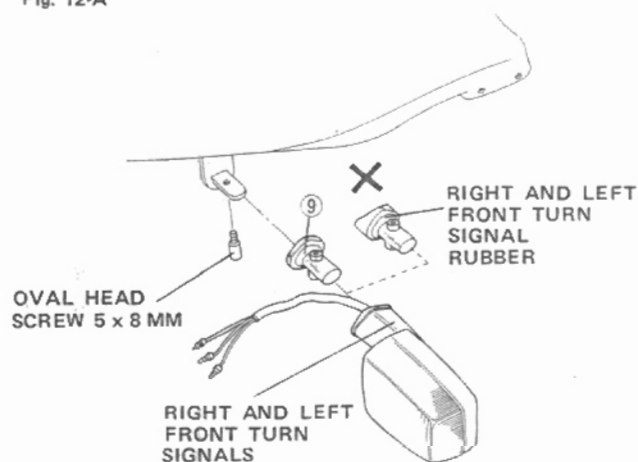

- a. Remove and discard the rubbers from the turn signals. Install the turn signals using a rubber (9) and 5 x 8 mm oval head screw for each. Connect the turn signal wires to the wire harness color-to-color.

- b. Route the right and left turn signal wires forward and secure with the wire clamps and bands as shown.

Fig. 12-B

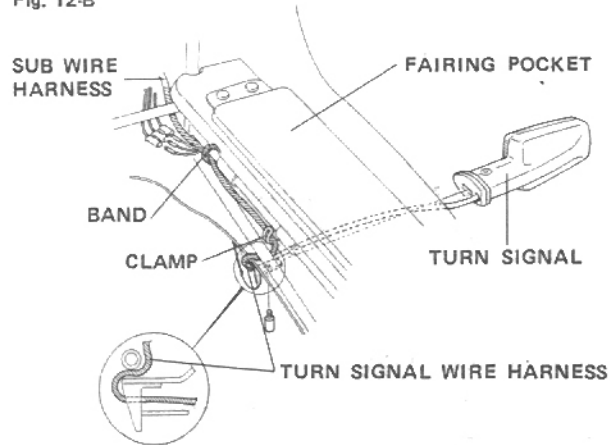

- 15) Remove the right and left rear view mirrors and install the plugs ③① in the holes made by removing the mirrors. Discard the mirrors.

- 16) Attach the caution labels as follows:

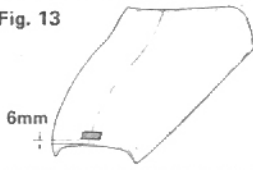
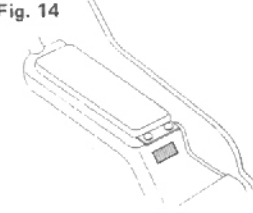
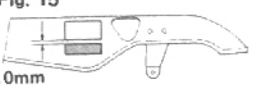
Name	Location
WINDSHIELD SCREEN CAUTION LABEL	Fig. 13 
FAIRING POCKET CAUTION LABEL	Fig. 14 
TIRE CAUTION LABEL	Fig. 15 

- 17) Reinstall the fuel tank and seat.
- 18) Connect the battery ground cable to the battery negative terminal.

PRE-DELIVERY SERVICE CHECK LIST

NOTE: Check all items listed on the following Pre-delivery Service Check List. Refer to Owner's manual or shop manual for specifications and detailed procedures. Always test ride the unit to make sure that it is functioning properly.

- ☐ Adjust clutch, check cable routing, and check operation.
- ☐ Adjust mirrors.
- ☐ Check choke operation and adjust idle speed.
- ☐ Check throttle grip free play, cable routing, and operation in all steering positions.
- ☐ Check tire pressure.

		Front	Rear
Cold tire pressures kg/cm ² (psi)	Up to 90 kg (200 lb) load	2.8 (40)	2.25 (32)
	90 kg (200 lb) load to vehicle capacity load	2.8 (40)	2.8 (40)

- ☐ Check operation and air pressure of front suspension.
- ☐ Inspect electrical components for proper operation and adjustment:
 - Headlight: Adjust high and low beam aim, and check high beam pilot light.
 - Turn signals.
 - Horn.
 - Engine stop switch.
 - Starter.
 - Instrument, flasher, oil pressure, headlight and neutral indicator lights.

- ☐ Check security of all nuts, bolts, and other fasteners.
- ☐ Check to ensure all applicable recall and product update campaigns are complied with.
- ☐ TEST RIDE: Check performance, handling, and operation:
 - Acceleration: Smoothness, etc.
 - Cruising: Smoothness, etc.
 - Handling: Stability and cornering.
 - Brakes: Smoothness and stopping power.
 - Idling: Smoothness, throttle response, return to idle.
 - Recheck idle speed after 10 minutes of stop and go driving.
 - Speedometer and Tachometer: Proper operation.
 - Upon completion of test ride, check for fuel, oil, or coolant leaks.

RULES FOR SAFER RIDING

Follow all safety notes and precautions described in the owner's manual and Owner's Instructions.

The weight of the accessory is shown below:

Weight added to motorcycle	12.5 kg (27.5 lbs)
----------------------------	--------------------

The overall weight added to the motorcycle is what concerns the rider. It is this weight that must be added to the total of the rider and cargo weights to be sure the vehicle load limit is not exceeded.